

MAT Table

STM11



The picture is only illustrative, it may not exactly match the product described.

Product description	Steel weldment carrying concrete board made of concrete class C 30/37 with dimensions 600×600×50 mm. The concrete surface of the table is attached to the central leg of dimensions 60×60×3 mm, which ends with a plate for anchoring to the base. The chessboard itself is created by pouring black concrete into a light board matrix.
Material	construction: stell grade 11, concrete class C 30/37 DOWNLOAD PDF SAMPLER >
Surface treatment	Concrete in shades natural light and anthracite. Galvanized steel treated with powder coating in colour variations: RAL 7016 (anthracite grey), RAL 9005 (jet black), RAL 9006 (white aluminium), RAL 9007 (grey aluminium). Other RAL shades according to RAL sampler on request only
Dimensions	600×600×740 mm
Anchoring	Anchoring is done with four stainless steel threaded rods M10 of length min. 100 mm and four nut cover caps M10 with a chemical anchor into concrete foundations prepared in advance. A detailed drawing is available for download on the website for each particular product.

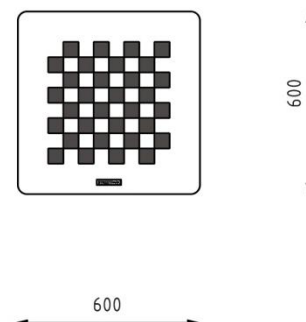
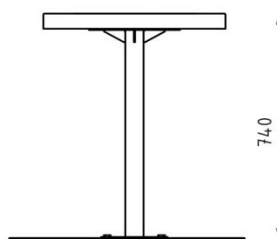
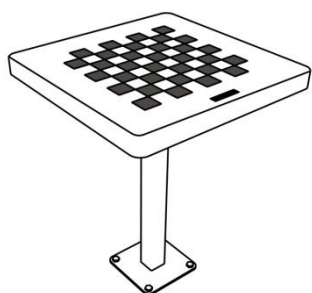

MAT Table

STM21



The picture is only illustrative, it may not exactly match the product described.

Product description	Steel weldment carrying concrete board made of concrete class C 30/37 with dimensions 600×600×50 mm. The concrete surface of the table is attached to the central leg of dimensions 60×60×3 mm, which ends with a plate for anchoring to the base. The playing board itself is created by pouring black concrete into a light board matrix.
Material	construction: stell grade 11, concrete class C 30/37 DOWNLOAD PDF SAMPLER >
Surface treatment	Concrete in shades natural light and anthracite. Galvanized steel treated with powder coating in colour variations: RAL 7016 (anthracite grey), RAL 9005 (jet black), RAL 9006 (white aluminium), RAL 9007 (grey aluminium). Other RAL shades according to RAL sampler on request only
Dimensions	600×600×740 mm
Anchoring	Anchoring is done with four stainless steel threaded rods M10 of length min. 100 mm and four nut cover caps M10 with a chemical anchor into concrete foundations prepared in advance. A detailed drawing is available for download on the website for each particular product.

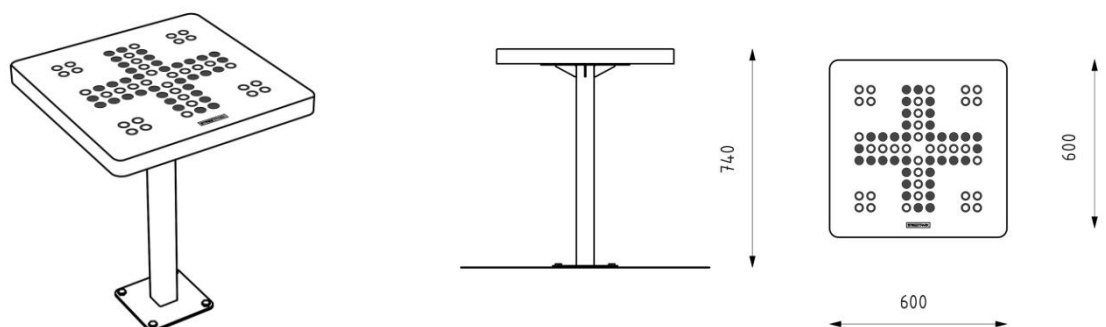

Projekts: **Evita Zavadska**
Klients: **FIXMAN SIA**
Datums: **03.11.2023**

FIXMAN

lapa 1/4

Produkta kods: **137609**
Produkta nosaukums: **Komunikācijas rotaļa**

1 gab

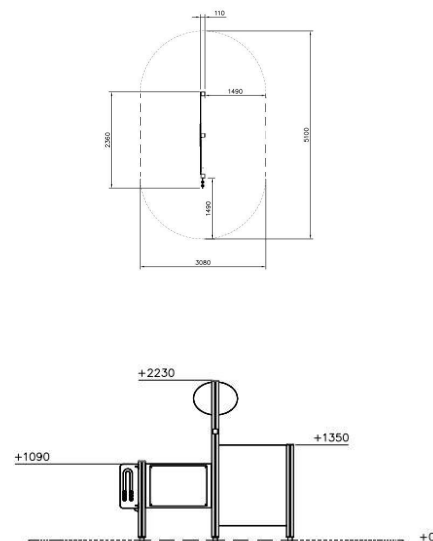
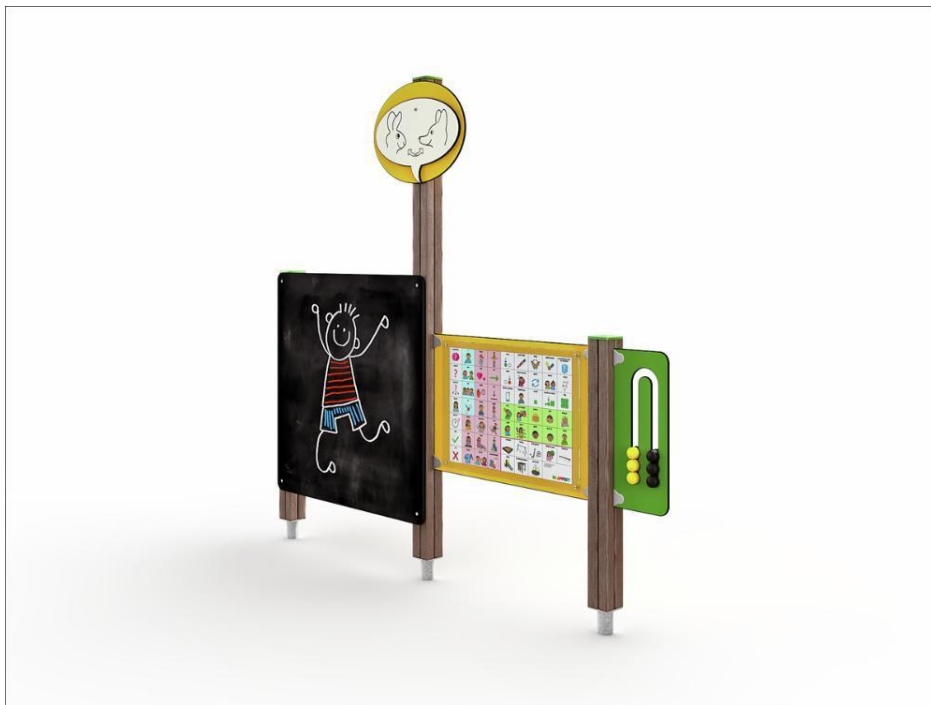

Apraksts:	Rotaļu elements ar tāfeli un 2 spēļu sienīnām.
Izmērs:	2360x110x2230
Drošības zona (m2):	14
Vecuma grupa:	1+
Produkta sērija:	Finno
Ražotājs:	Lappset
Tehniskais apraksts:	Iekārta ierokama un nostiprināma zemē. Iekārta ir nostiprināta ar nerūsoša metāla kājām 60 mm diametrā.
Izejmateriāli:	Rotaļu kompleksa balsti, sētiņas: impregnēts ziemeļu priedes koks pārklāts ar ūdens dispersijas krāsu uz metāla pēdām; rotaļu sienīņa- augstspiediena lamināts (HPL); papildelementi- plastmasa; nerūsošs tērauds.
Standarts:	EN 1176

Produkta kods: **PPFRECADGF**
 Produkta nosaukums: **Alto diatons (Ierakts zemē)**

1 gab

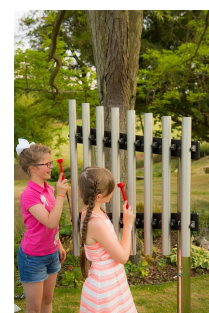

Apraksts:	Alto Diatonic ir noskaņota diapazonā C4-C5;
Izmērs:	930x1080 mm
Produkta sērija:	Mūzikas instrumenti
Ražotājs:	Percussion Play
Tehniskais apraksts:	Instrumentu sastāv no alumīnija 7 vertikāliem zvaniem; Zvani pie karkasa ir piestiprināti ar nerūsoša tērauda drošības skrūvē un stiprinājumiem augšā un apakšā- katram zvanam- 4 skrūves; Instrumentu spēlējams ar divām vālitēm, kuras ir piestiprinātas trosēs; Instrumentu ir izveidots tā, lai to ērti varētu lietot arī cilvēki ratiņkrēslā; Iekārtair ierokama un betonējama zemē; Paredzēts uzstādīšanai brīvdabas apstākļos- vandālisma un āra laika apstākļu drošs;
Izejmateriāli:	Mūzikas instruments izgatavots no alumīnija caurulēm un nerūsoša tērauda stabiem; Papildmateriāli- plastmasa; nerūsošs tērauds;

Produkta kods: **060405**
Produkta nosaukums: **Specializēto šūpoļu rampa**

1 gab

Apraksts:	Alumīnija uzbraukšanas rampa specializētajām šūpolēm "Oasis".
Izmērs:	1000x1000mm
Produkta sērija:	Mazās arhitektūras formas
Ražotājs:	Lappset
Tehniskais apraksts:	Alumīnija rampa uzbraukšanai, kas paredzēta, lai cilvēki ratiņkrēslā varētu piekļūt šūpolēm. Iekārta paredzēta uzstādīšanai brīvdabas apstākļos.
Izejmateriāli:	Rampa - alumīnijs.

Table
Ping-Pong
VMOTCE

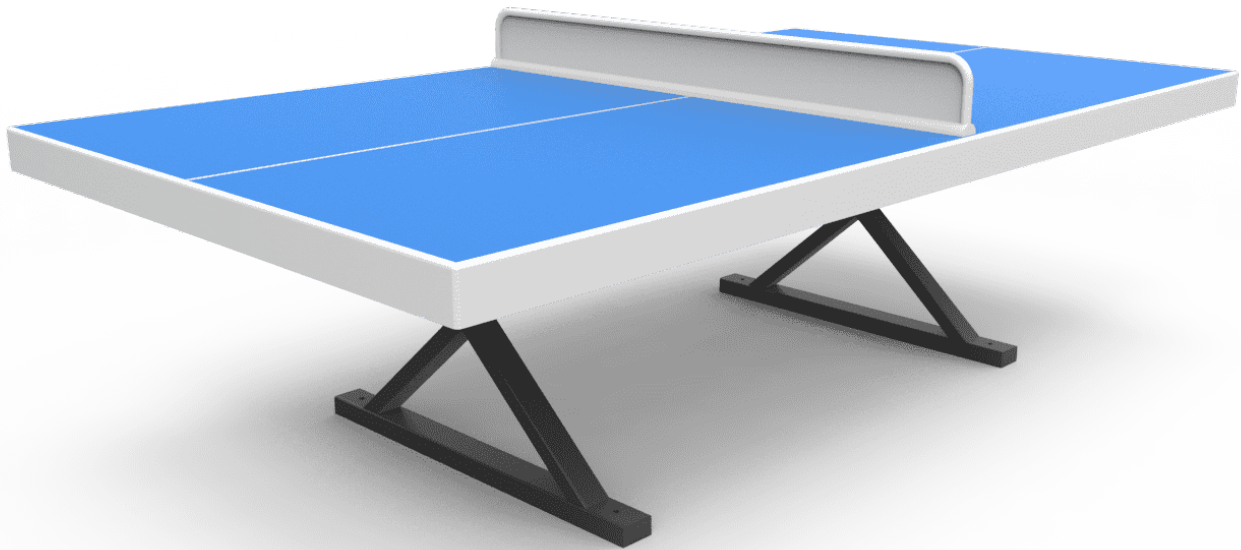
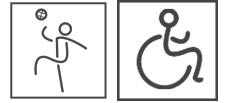
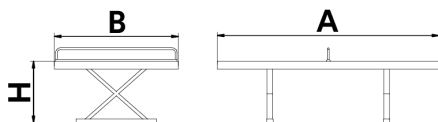

Table made with metal inner chassis covered with polyester and pressed inner nucleus made of polurethane and fibreglass. Anti-vandalism stable and robust ping-pong table suitable. Anti-shock and anti-graffiti properties. Ping-pong regulation white lines inlaid in the surface so they cannot be rubbed out nor lose their clarity. Anti-slippery surface which produces an active bounce of the ball.



Ref. A B H
VMOTC 2740 1525 760

[Project sheet](#) | [CAD](#) | [Catalogue](#) | [Mounting instructions](#) | [HD image](#)

Materials:

Finish: Net: primer expoxi ZINC + powder coating. Structure: sandblasting + powder coating.

Fixing: by means of 4 bolts M12.

The constant improvement and evolution of our products may result in some modifications of the technical specifications and characteristics of the products without prior notice.

Projects:

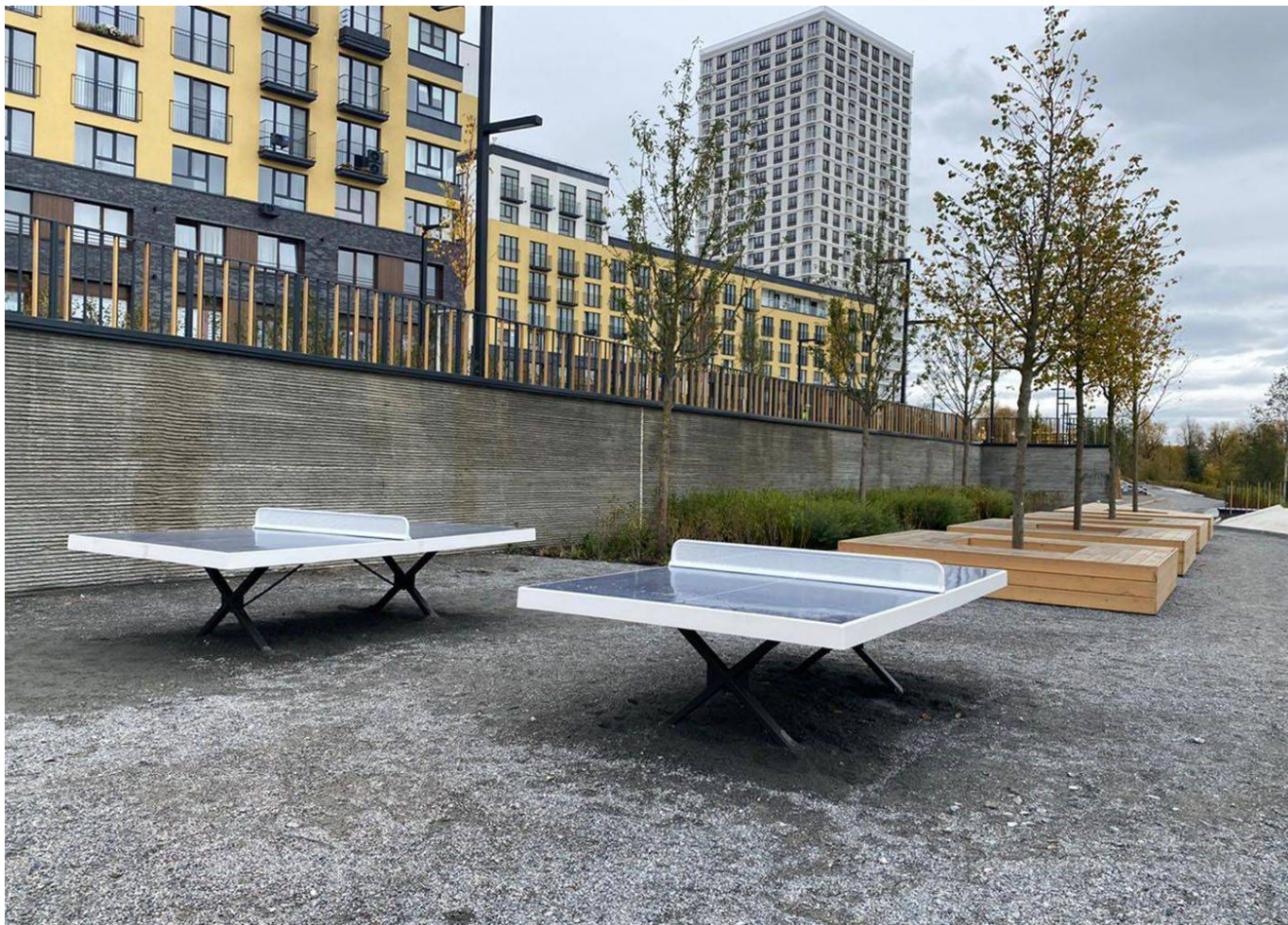

The constant improvement and evolution of our products may result in some modifications of the technical specifications and characteristics of the products without prior notice.

BENITO

info@benito.com
tel. 93 852 1000

